

# Quick-assembly insulating panel, type FV for high-quality exclusive panel construction

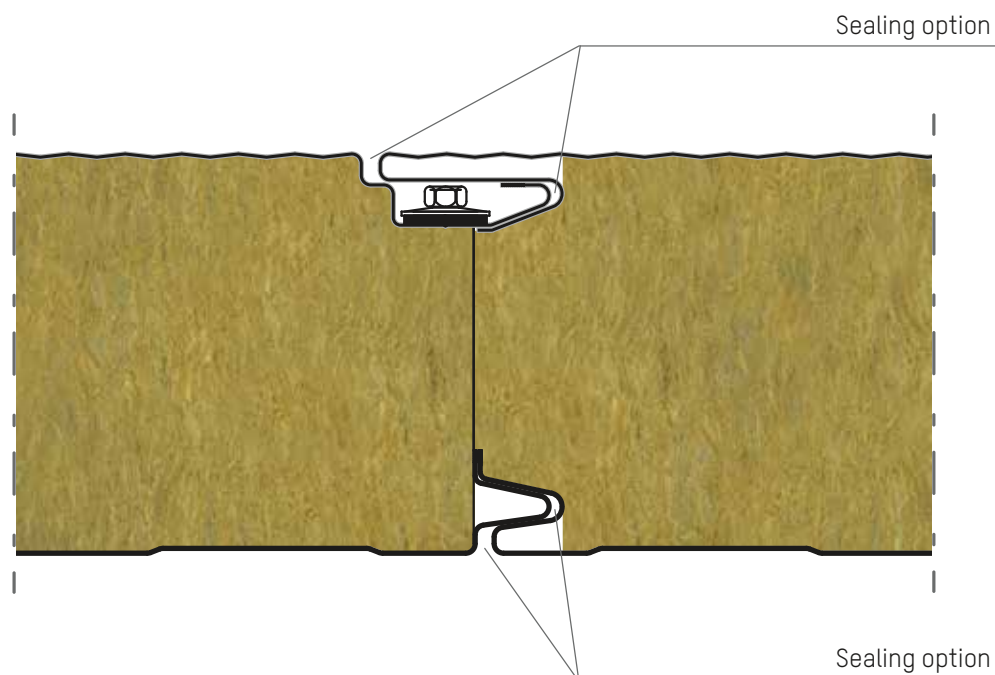

- Exclusive facade with hidden joints
- 3 different surface profile variants
- Available in two different volume weights, as required per application
- Quick and easy assembly
- Vertical or horizontal assembly possible
- Module width 1000mm
- Insulation thicknesses 60, 80, 100, 120, 140, 170, 200, 240mm

# Quick-assembly insulating panel, type FV with external and internal steel cladding

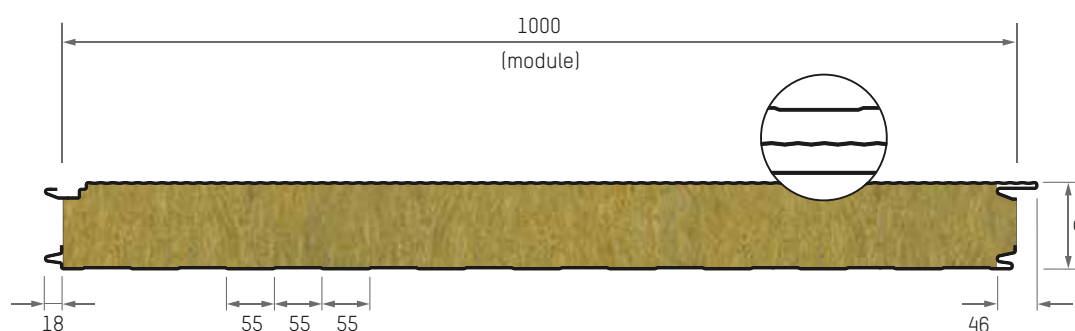

**Cladding layers** Coil galvanized and coated sheet steel with organic coating materials, further cladding layers are available on request

## Surface finishes

**Standard:** External face: microlined (14mm), Internal face: profiled (55mm)

**Extra charge:** External face: profiled (55mm) or smooth, internal face: smooth

## Insulating core

Mineral wool, fiber-adjusted, water-repellent and non-flammable A1  
Density FV: 100kg/m<sup>3</sup>, FV+: 135kg/m<sup>3</sup>

## Fire tests

 Euro class A2-s1, d0

 FM Approval

## Fire resistance\* acc. to classification report

FV+060-EI30; FV+100-EI120; (4m, vertically)

## Approval

Notification of approval Z-10.49-511 of the DIBt Berlin in accordance with DIN EN 14509 (CE marking)

## Available lengths

Up to 15m, depending on panel thickness

## Production tolerances

In accordance with DIN EN 14509

## Sound insulation

Approx. 30dB for all panel thicknesses

## Statics

See our span tables

Panel type		FV060	FV080	FV100	FV120	FV140	FV170	FV200	FV240
<b>Density</b>	kg/m <sup>3</sup>	100							
<b>Panel thickness</b>	mm	60	80	100	120	140	170	200	240
<b>Cladding layer thickness</b>									
<b>External</b>	mm	0.6	0.6	0.6	0.6	0.6	0.6	0.6	0.6
<b>Internal</b>	mm	0.5	0.5	0.5	0.5	0.5	0.5	0.5	0.5
<b>Panel weight approx.</b>	kg/m <sup>2</sup>	15.6	17.6	19.6	21.6	23.6	26.6	29.6	33.6
<b>U-value acc. to EN 14509 with joint</b>	W/(m <sup>2</sup> ·K)	0.675	0.549	0.461	0.356	0.305	0.250	0.212	0.177
<b>Panel type</b>		FV+060	FV+080	FV+100	FV+120	FV+140	FV+170	FV+200	FV+240
<b>Density</b>	kg/m <sup>3</sup>	135							
<b>Panel weight approx.</b>	kg/m <sup>2</sup>	17.4	20.1	22.8	25.5	28.2	32.2	36.3	41.7
<b>U-value acc. to EN 14509 with joint</b>	W/(m <sup>2</sup> ·K)	0.731	0.597	0.469	0.388	0.332	0.272	0.231	0.193

\*No application approval for Germany