

Instructions - System solution

MIWO/PIR - Type D

Insulating panel type FP/P

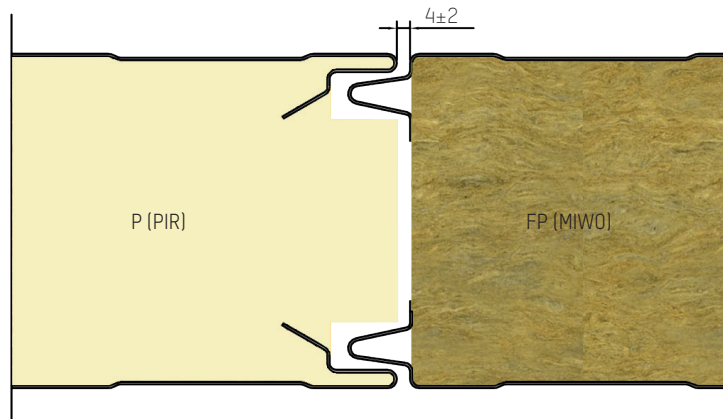

Work steps:

- 1.) up to FP080, apply seal tape (5x20mm) item no. 1008429 to MIWO panel
 from FP100 apply seal tape (5x40mm) item no. 1008430 to MIWO panel

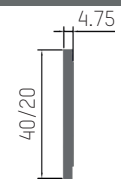

- 2.) Slide the panels together

- 3.) Fasten the panels

Example: FPD100/P100, MIWO/PIR

