

## Order form - System solution Type C and Type D

### PIR/MIWO - Type C

Insulating panel type P/FP

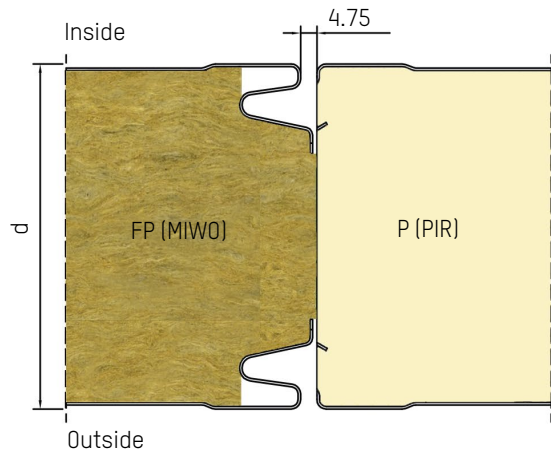

PIR panel type PC	
Thickness (mm)	
Amount	
Length (mm)	
MIWO panel type FP	
Thickness (mm)	
Amount	
Length (mm)	

### MIWO/PIR - Type D

Insulating panel type FP/P

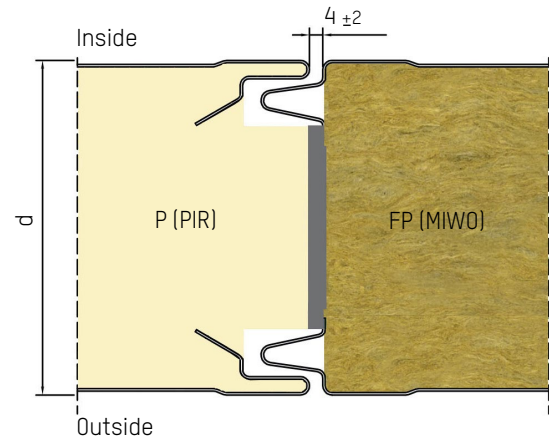

MIWO panel type FPD	
Thickness (mm)	
Amount	
Length (mm)	
PIR panel type PD	
Thickness (mm)	
Amount	
Length (mm)	

The crossing panels are packed and labeled separately (MIWO und PIR separated).